



Robotic Pool Cleaner

For Commercial - Public Swimming Pools

Operator Manual

Robot limpiapiscinas

Para piscinas públicas y privadas

Manual de operación

Schwimmbeckenreiniger

Für kommerzielle und öffentliche Schwimmbäder

Bedienungsanleitung

Robot pulisci-piscine

Per piscine pubbliche e private

Manuale di utilizzo

Robot nettoyeur

Pour piscines publiques et privées

Manuel d'utilisation

Robot Aspirador

Para piscinas públicas e privadas

Manual de funcionamiento

BK 0002500/ REV PC

REPLACING THE BATTERY

The battery installed in the remote control can last several years. If the battery needs replacing, the red light on the remote control unit will not flash when a button is pressed.

To replace the battery:

1. Unscrew the 6 screws securing the back cover of the unit using a Philips screwdriver.
2. Remove the battery and dispose of safely.
3. Replace it with a size $\frac{1}{2}$ AA 3.6V lithium battery (type 14250). Observe the correct polarity.
4. Replace the cover and secure the 6 screws. Be sure not to over tighten.

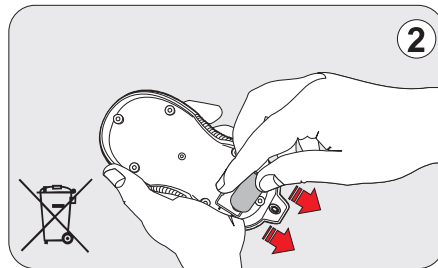
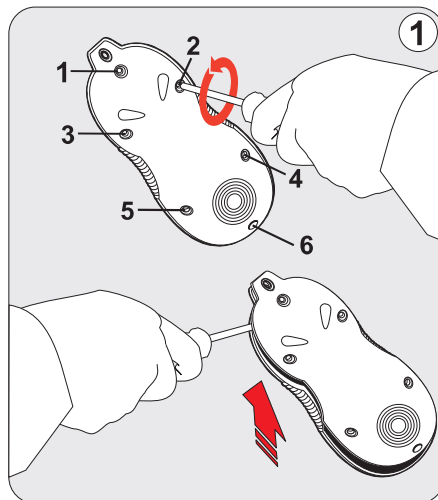

NOTE:



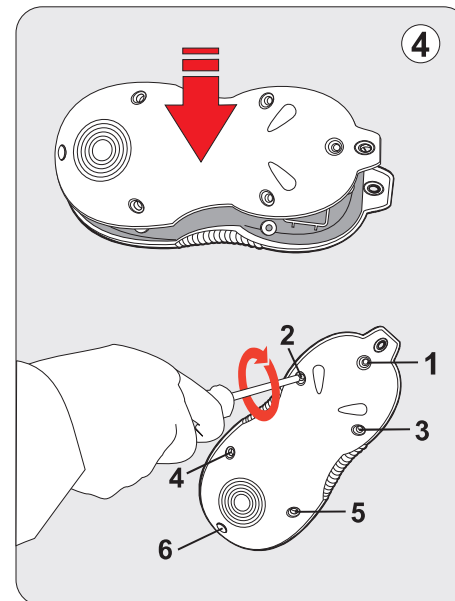
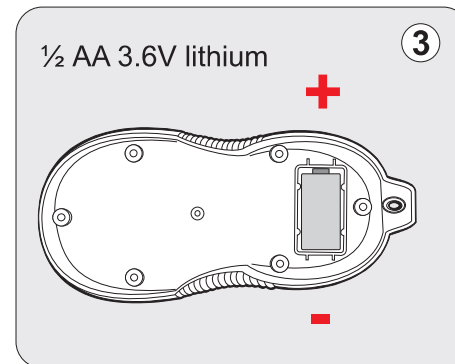

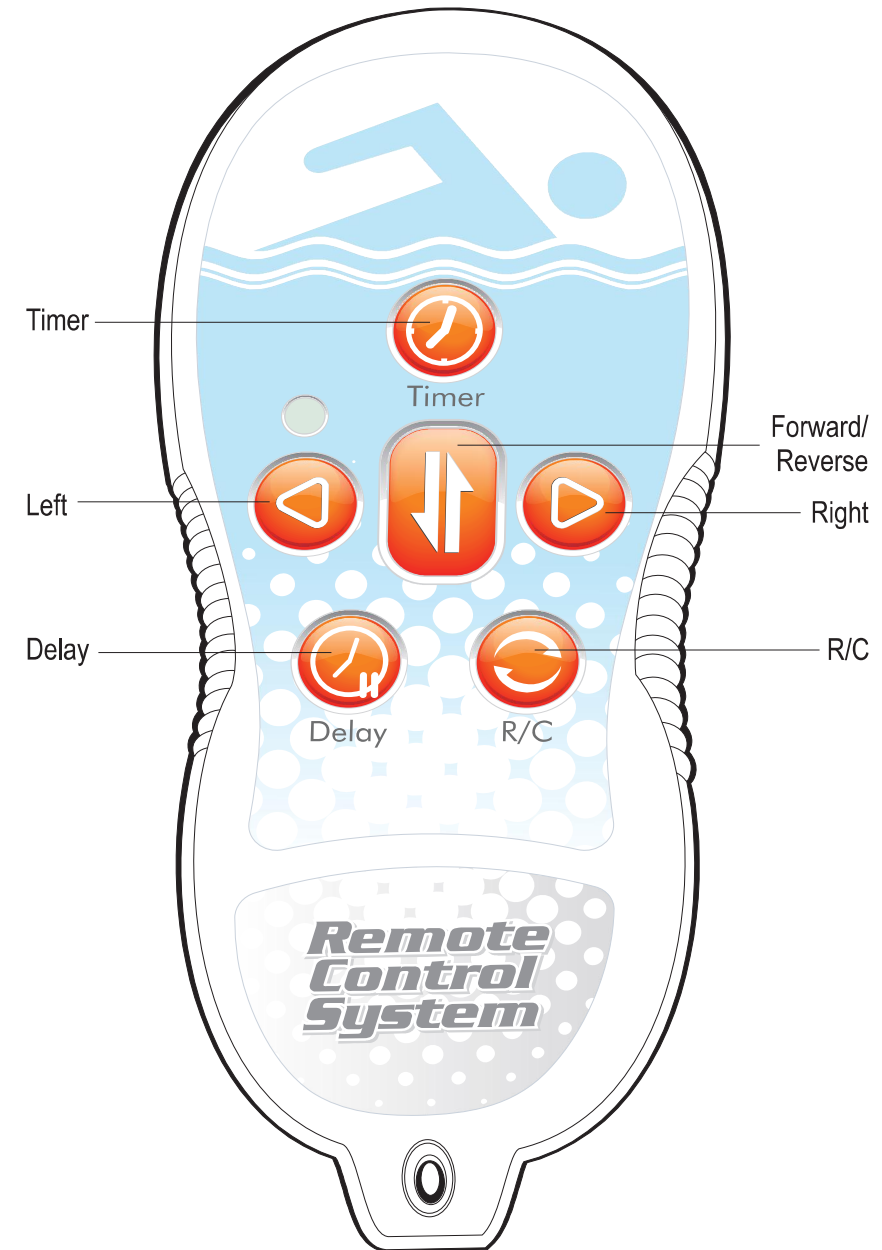

Dispose of the battery safely. Do not recharge, short circuit, crush, disassemble, heat above 100°C (212°F), incinerate, or expose contents to water.



Remote Control



Remote Control Functions

	Timer	<p>Sets the Cycle Time.</p> <p>Pressing the Timer button changes the Cycle Time on the Power Supply.</p> <p>Each press of the Timer button changes the Cycle Time to the next Cycle Time option : 3, 5, 7, 9*.</p>
	Change Direction	<p>Changes the Robotic Cleaner's current direction of motion.</p> <ul style="list-style-type: none"> • If the Robotic Cleaner is currently moving forward, pressing the Change Direction button causes the Robotic Cleaner to move backward. • If the Robotic Cleaner is currently moving backward, pressing the Change Direction button causes the Robotic Cleaner to move forward.
	Turn Left	Turns the Robotic Cleaner to the left for as long as the Turn Left button is pressed.
	Turn Right	Turns the Robotic Cleaner to the right for as long as the Turn Right button is pressed.
	Delay	<p>The delay feature allows the user to postpone the beginning of a cleaning cycle. Using this feature gives time for the debris to settle down to the pool floor resulting in a more effective cleaning cycle.</p> <ul style="list-style-type: none"> • Pressing the Delay button sets the Delay Time to 2 hours. • After the Delay Time has been set to 2, another press of the Delay button resets the Delay Time to 0 (no delay).
	R/C	<p>Changes the Robotic Cleaner's current Operating Mode: Manual Mode or Automatic Mode.</p> <ul style="list-style-type: none"> • If the Robotic Cleaner is currently in Manual Mode, pressing the R/C button changes the Robotic Cleaner to Automatic Mode. • If the Robotic Cleaner is currently in Automatic Mode, pressing the R/C button changes the Robotic Cleaner to Manual Mode.

* Certain models